



Underlayment ONE VAPOR BARRIER

UNDERLAYMENT FOR ACOUSTIC INSULATION
WITH PRE-ATTACHED VAPOR BARRIER

96.9
SFT



Vapor
Barrier



Dimension
35.4" x 32.8'



Thickness
1.8 mm

TECHNICAL PROPERTIES



★★★★★

Moisture protection



★★★★☆

Reduction
of impact noise



★★★★☆

Thermal
resistance



★★★★★

Compensates
for uneven floor



★★★★★

Protection
from damage
from falling objects

Material Description & Properties

Blend of cork granules and recycled PET foams with a PET film Vapor Barrier and a PET textile carrier⁽¹⁾ for sound insulation. More than 70% of recycled materials.

KEY FEATURES

- 2 in 1 solution: Pre-attached vapor barrier for moisture protection.
- Excellent acoustic insulation.
- Low thermal resistance.
- Durable against loads.
- Designed according to circular economy concept.

(1) May contain vestiges of fiber glass and balsa

TECHNICAL DATA

TEST	REQUIREMENT	UNIT	RESULT
Punctual conformability (PC)	≥ 0.5	mm	> 0.7 > 1.2 ⁽³⁾
Compressive strenght (CS)	≥ 60	kPa	> 150
Compressive creep (CC)	≥ 10	kPa	> 35
Impact Insulation Class (IIC ΔIIC)*	–	dB	76 21
Sound Transmission Class (STC)*	–	dB	76
Thermal Resistance (R) ⁽²⁾	≤ 0.15	m²°C/W	0.036
Dynamic load (DL25)	≥ 10 000	cycles	100 000
Moisture Protection (SD)	≥ 75	m	> 75

(2) Suitable for underfloor heating and cooling

(3) Film side | Fabric side

* With ceiling.

THERMAL INSULATION

Thermal Conductivity ⁽¹⁾	0.05 W/mK
Thermal Resistance	0.036 (m ² °C/W)

⁽¹⁾ EN 8301

ACOUSTICAL RESULTS

Flooring	Laminate floor
Thickness (mm)	1.8
Impact Insulation Class (IIC Δ IIC) * ⁽¹⁾	76 21
Sound Transmission Class (STC) * ⁽²⁾	76

⁽¹⁾ ASTM E989-21
⁽²⁾ ASTM E90-09; ASTM E2235-04 and ASTM E413-22
 * With ceiling

TEST APPARATUS (IIC | Δ IIC | STC)

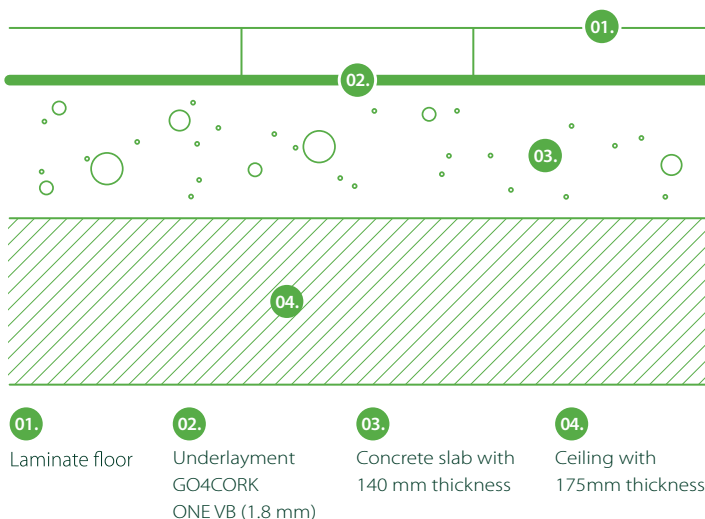

APPLICATION SCHEMES

NON-GLUED FLOORS



GENERAL INSTALLATION INSTRUCTIONS

GENERAL INSTALLATION INSTRUCTIONS

The following installation instructions are recommended by Amorim Cork Solutions, and are not intended to be a definitive project specification. They should be interpreted and applied taking into account the recommendations of the manufacturers of the flooring to be installed.

1. PREPARATION OF THE SUBFLOOR

- The subfloor must be level, dry, clean and in good structural conditions. A floor is considered level if the deviation height is less than 2mm over a distance of 2.5 linear meters. Deviations above this value must be leveled out before underlayment installation.
- The humidity content of the concrete substrate must not exceed 2.5 % (MC) by weight. Any moisture problems need to be solved before installation. New concrete slabs need to cure for at least 120 days before installation.
- The environmental conditions during the installation should be: temperature >10°C and humidity <75%

2. INSTALLATION OF THE UNDERLAYMENT

This underlayment must be installed with the vapor barrier facedown on the subfloor. Place one roll of the underlayment parallel to the wall and in the opposite direction you plan to install the final floor to reduce seams. Cut the underlayment material roll to the desired length and install it directly, covering the entire surface of the room. When unrolling your rolls, install the next row immediately next to the previous one. However, be sure to not overlap the underlayment edges nor leave any gaps. Use a tape to securely seal the rows together and assure seamless moisture seal between rows. Never mechanically secure the underlayment with screws, nails or staples as this may compromise its effectiveness. Install the final floor perpendicularly to the underlayment. Always follow the flooring manufacturer's recommended installation instructions.

APPLICATION PROCESS

FLOATING INSTALLATION WITH PRE ATTACHED VAPOR BARRIER

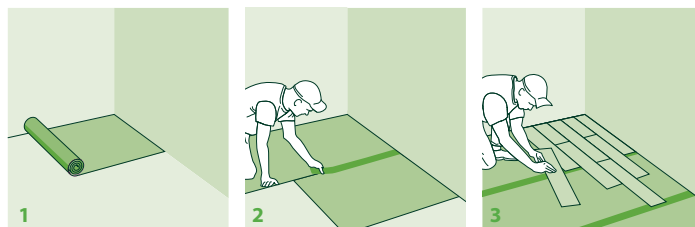

1. Installation of underlayment; 2. Installation of the tape; 3. Installation of final flooring;

**AMORIM
CORK
SOLUTIONS**

The data provided in this Material Data Sheet represents typical values. This information is not intended to be used as a purchasing specification and does not imply suitability for use in a specific application. Failure to select the proper product may result in either equipment damage or personal injury. Please contact Amorim Cork Solutions regarding specific application recommendations. Amorim Cork Solutions expressly disclaims all warranties, including any implied warranties or merchantability or of fitness for a particular purpose. Amorim Cork Solutions is not liable for any indirect special, incidental, consequential, or punitive damages as a result of using the information listed in this MDS. Any of its material specification sheets, its products or any future use or re-use of them by any person or entity. For contractual purposes, please request our Product Specifications Sheet (PDS).

www.amorimcorksolutions.com