

# T92 SELECTION

## Agglomerated cork underlayment for impact noise, thermal insulation and LVT click protection

### PRODUCT SPECIFICATION

Resilient acoustic underlayment made of agglomerated cork with PU (polyurethane) elastomer bonding agent for impact noise insulation for LVT, SPC and WPC floors, with a density up to 350kg/m<sup>3</sup>.

### KEY FEATURES

- ▶ Natural material
- ▶ High durability and long term resilience
- ▶ High performance with reduced thickness
- ▶ Low residual indentation and free of migration of plasticizers
- ▶ Homogeneous material produced from cork granules with (0.5-1mm)

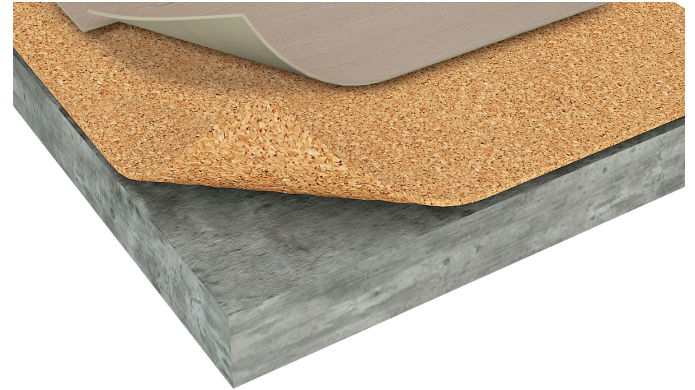

### PHYSICAL AND MECHANICAL PROPERTIES

Specific Weight (kg/m <sup>3</sup>   lb/ft <sup>3</sup> ) ①	250-350   15-22
Tensile Strength (kPa) ①	> 500
Compression at 0.7MPa (%) ①	10-20
Recovery after 0.7MPa (%) ①	> 70

① ISO 7322

### TECHNICAL PROPERTIES

Flooring	LVT		
Thickness	mm	1.6	1.6
Thermal Resistance (TR) ①	m <sup>2</sup> .°C/W	0.032	0.032
Floor Durability			
Punctual Conformability (PC) ①	mm	< 0.5	< 0.5
Compressive Strength (CS) ①	kPa	> 400	> 400
Compressive Creep (CC) ①	kPa	>50	>50
Water Vapor Resistance (SD) ①	m	NA	> 75
Vapor Barrier		○	●

① EN 16354    TBD To be determined    NA Not applicable    ● Yes    ○ No

## ACOUSTIC RESULTS

Flooring		LVT	LVT	SPC ④	SPC ④
Flooring Thickness	mm	6	6	7	5.5
Underlayment Thickness	mm	1.6	1.6	1.6	1,6
Impact Insulation (IS) ①	dB (ISO)	17	17	18 ③	17 ⑤
IIC   $\Delta$ IIC ②	dB (ASTM)	—   —	—   —	—   —	—   —
Sound Transmission (STC) ③	dB (ASTM)	—	—	—	—
System (Glued   Floating)		Floating	Floating	Floating	Floating
System (Ceiling)		○	○	○	○

① Standard ISO 717-2:2013 ② Standard ASTM E413 ③ Standard ASTM E989-89 ④ Hydro Natural ⑤ ISO 1625-1 ● Yes ○ No

Impact Sound (IS) · LVT (6mm) · T96 (1.6 mm)

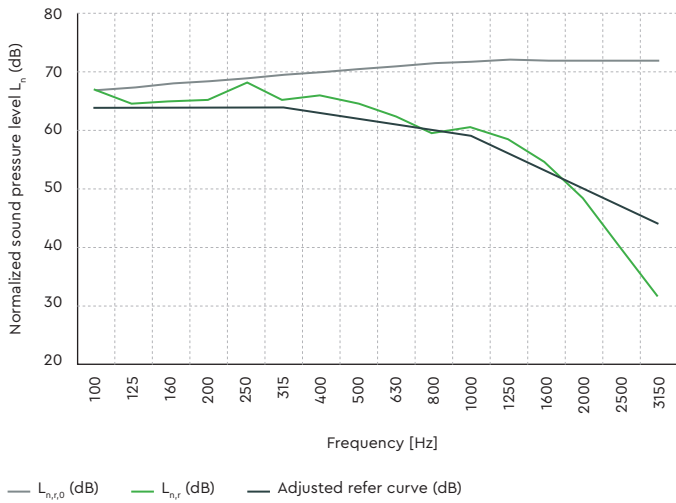

Sound (IS) · SPC (7.0mm) · T92 (1.6mm) · Floating

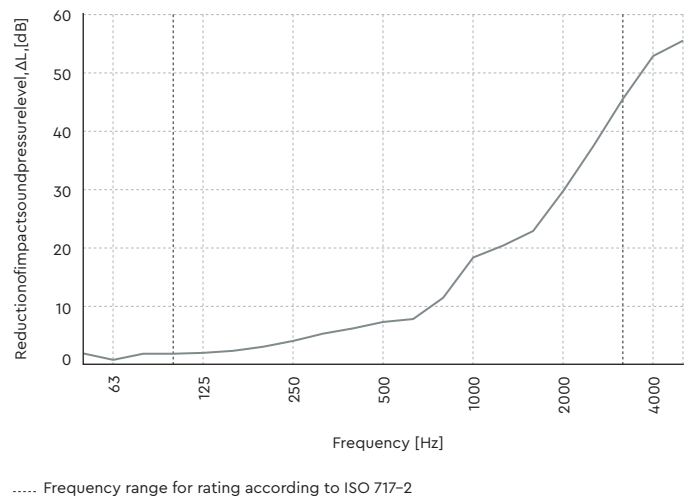

Sound (IS) · SPC (5.5mm) · T92 (1.6mm) · Floating

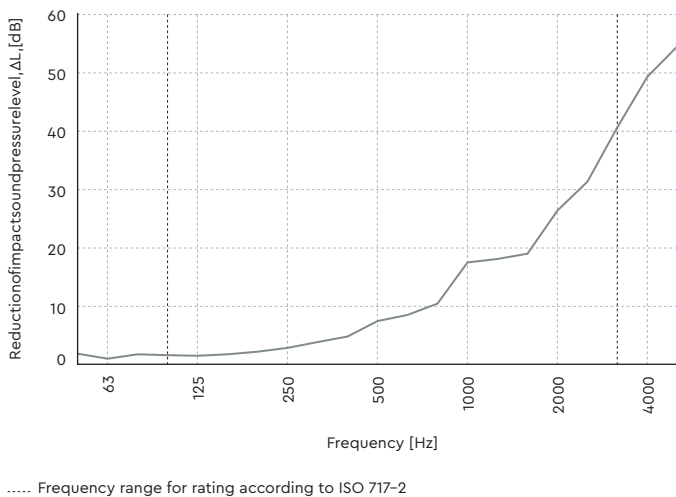

## TEST APPARATUS ( $\Delta L_w$ )

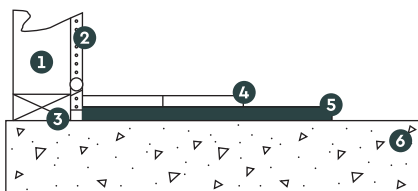

- 1 Wall
- 2 Wall board
- 3 Perimeter isolation barrier (optional)
- 4 LVT
- 5 Acousticork T92
- 6 Subfloor concrete slab

## INSTALLATION

### NON GLUED FLOORS



- 1 Reinforced concrete slab
- 2 Agglomerated cork resilient layer – Acousticork T92
- 3 Perimeter insulation barrier (optional)
- 4 Vapor barrier (for wood based flooring)
- 5 Floor covering composed by non glued wood floor

\*Product images and illustrations are for illustrative purposes only.

## GENERAL INSTALLATION INSTRUCTIONS

The following installation instructions are recommended by Amorim Cork Solutions, but are not intended as a definitive project specification. They are presented in an attempt to be used with recommended installation procedures of the flooring installer.

### Final Flooring

Always follow manufacturers recommended installation instructions, particularly when adhesives are recommended.

### Recommended Adhesives

LVT floor to Acousticork: Water-Based Emulsion/Polyurethane Glue;

### Important Notes

Never mechanically fasten the Acousticork T92 to the flooring floor as this will severely diminish its acoustical value.

For more detailed installation instructions, please contact us.

Never install a wood or laminate floor without vapor barrier (integrated or applied before the underlayment).

## APPLICATION PROCESS · FLOATING FLOOR · NON-VAPOR BARRIER UNDERLAYMENT

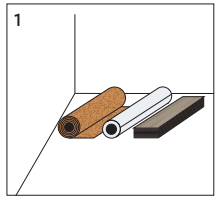

These are all the materials needed to install the underlayment.

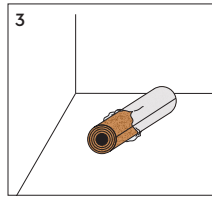
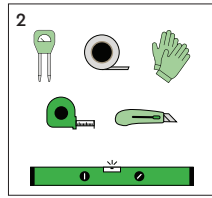

For the installation process, open the packaging 48 hours in advance and leave for acclimatization

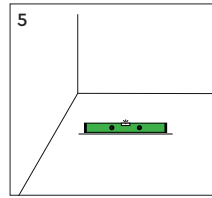
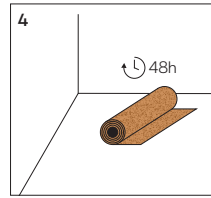

Subfloor preparation: Make sure that the subfloor is leveled, dry, clean and in good structural conditions.

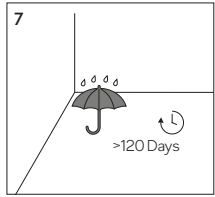
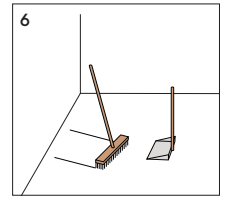

New concrete slabs must be left to cure for 120 days before installation.

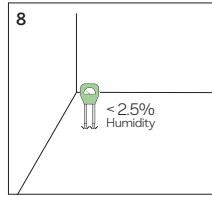

The humidity content of the substrate is critical: it must not exceed 2.5% (MC).

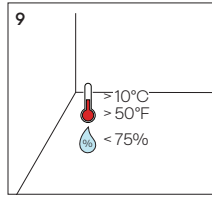

Air temperature should be above 10°C and air humidity below 75%.

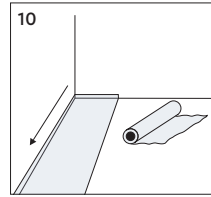

You must first install a moisture barrier across the entire area of the room. It should be installed following the outline of the enclosing wall.

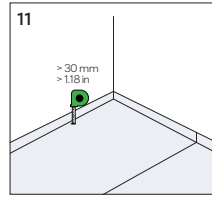

Use a height of at least 30 mm and with a minimum overlap of 100mm using a sealing tape to seal the seams.

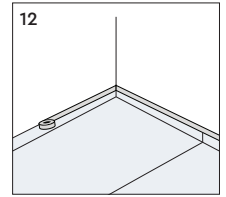

The barrier must be installed directly onto the surface of the subfloor. Use a sealing tape to seal the rows securely together.

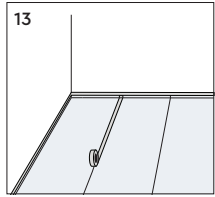

The installation should be in the opposite direction you plan to install the underlay to reduce seams, in the same direction of the final floor.

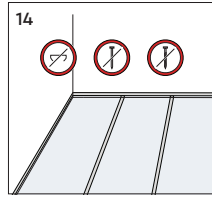

Never mechanically secure the barrier with screws, nails or staples, since this may undermine its effectiveness.

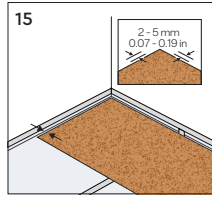

Leave a little space between the wall and the underlayment.

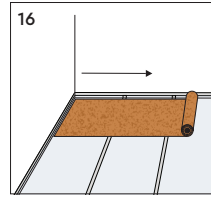

The underlayment should be installed in a perpendicular direction to the final floor, which should always be installed in the direction of natural light incidence in the room.

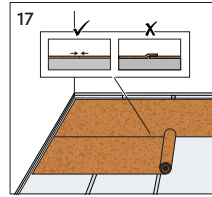

The underlayment must cover the entire area without any gaps nor overlaps.

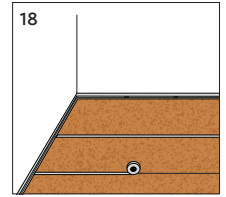

To securely joined using sealing tape.

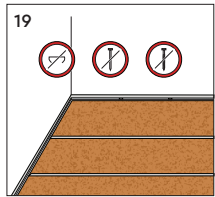

Never mechanically secure the underlayment with screws, nails or staples, since this may undermine its effectiveness.

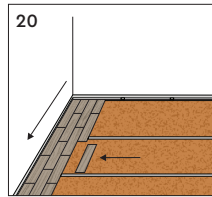

Install the flooring in a perpendicular direction to the underlayment.

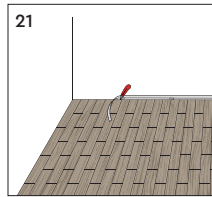

Cut off excess moisture barrier.

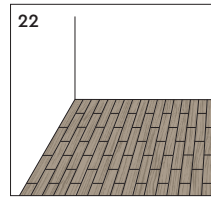

Always follow the flooring manufacturer's recommended installation instructions.

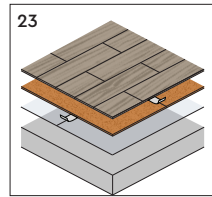

Total System.

## TECHNICAL DATA SHEET T92 SELECTION

The data provided in this Technical Data Sheet represents typical values. This information is not intended to be used as a purchasing specification and does not imply suitability for use in a specific application. Failure to select the proper product may result in either equipments damage or personal injury. Please contact Amorim Cork Solutions regarding specific application recommendations. Amorim Cork Solutions expressly disclaims all warranties, including any implied warranties or merchantability or of fitness for a particular purpose. Amorim Cork Solutions is not liable for any indirect special, incidental, consequential, or punitive damages as a result of using the information listed in this TDS. Any of its material specification sheets, its products or any future use or re-use of them by any person or entity. For contractual purposes, please request our Product Specifications Sheet (PDA).