



# T47 VERSATILE

## Agglomerated cork and recycled PU foam underlayment for impact noise and LVT floor protection

### PRODUCT SPECIFICATION

Resilient acoustic underlayment made of agglomerated cork and recycled PU foam with PU (polyurethane) elastomer bonding agent for impact noise insulation for LVT, SPC or WPC floors, with a density up to 420 kg/m<sup>3</sup>.

### KEY FEATURES

- ▶ High durability and long term resilience
- ▶ High performance with reduced thickness
- ▶ Impact noise reduction
- ▶ Recycled materials



### PHYSICAL AND MECHANICAL PROPERTIES

Specific Weight (kg/m <sup>3</sup>   lb/ft <sup>3</sup> ) ①	320-420   20-26
Tensile Strength (kPa) ①	> 350
Compression at 0.7MPa (%) ①	20-45
Recovery after 0.7MPa (%) ①	> 70

① ISO 7322

### TECHNICAL PROPERTIES

Flooring		LVT
Thickness	mm	1.9
Thermal Resistance (TR) ①	m <sup>2</sup> ·°C/W	0.037
Floor Durability		
Punctual Conformability (PC) ①	mm	> 0.5
Compressive Strength (CS) ①	kPa	> 200
Compressive Creep (CC) ①	kPa	—
Water Vapor Resistance (SD) ①	m	NA
Vapor Barrier		O

① EN 16354    TBD To be determined    NA Not applicable    ● Yes    ○ No

ACOUSTIC RESULTS

Flooring			LVT	Laminate
Flooring Thickness	mm	7.3	7.3	12
Underlayment Thickness	mm	1.9	1.9	1.9
Impact Insulation (IS) ①	dB (ISO)	18	17	—
Impact Insulation IIC   ΔIIC ②	dB (ASTM)	74   35	—	75   37
Sound Transmission (STC) ③	dB (ASTM)	76	—	76
System (Glued   Floating)	Floating		Floating	Floating
System (Ceiling)	●		○	●

① Standard ISO 717-2:2013 ② Standard ASTM E413 ③ Standard ASTM E989-89 ● Yes ○ No

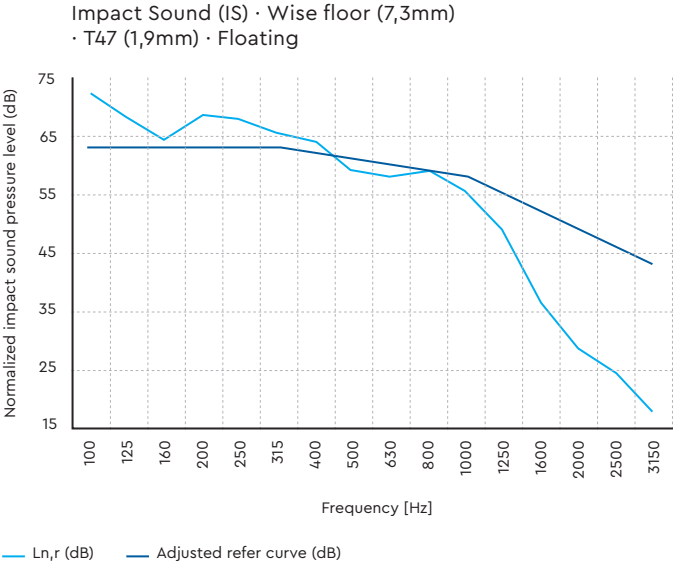
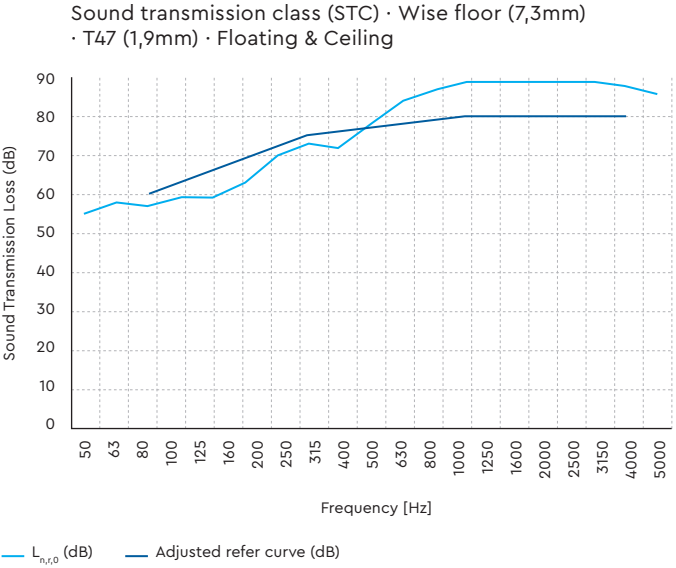
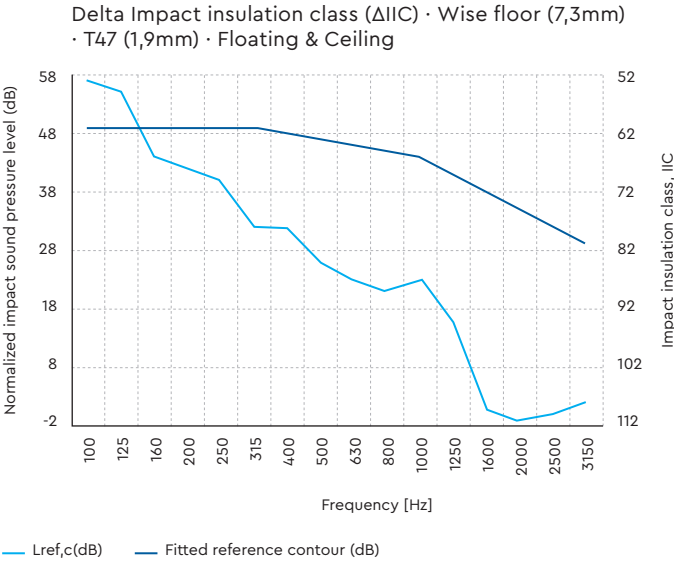
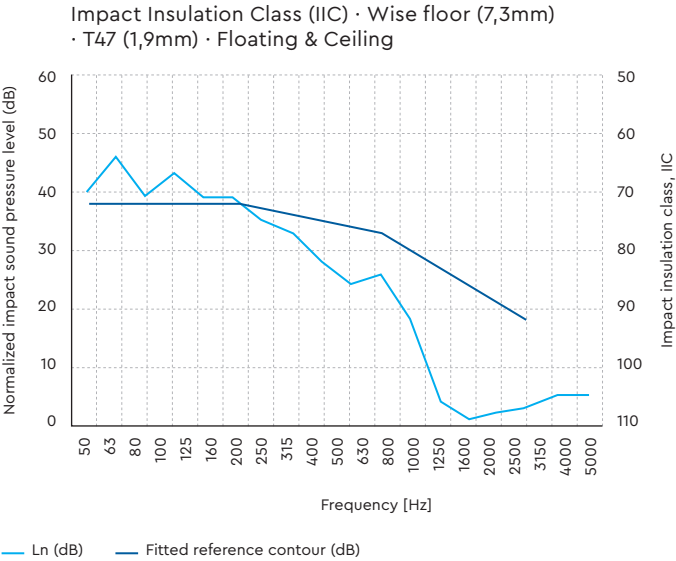

ACOUSTIC RESULTS

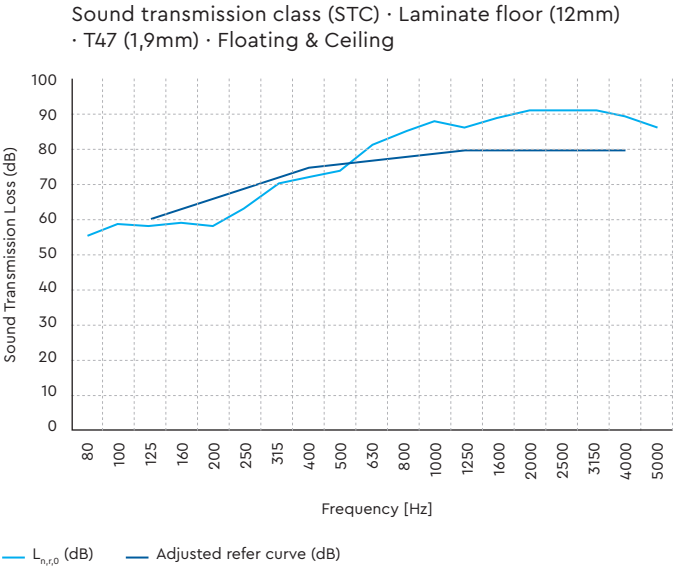
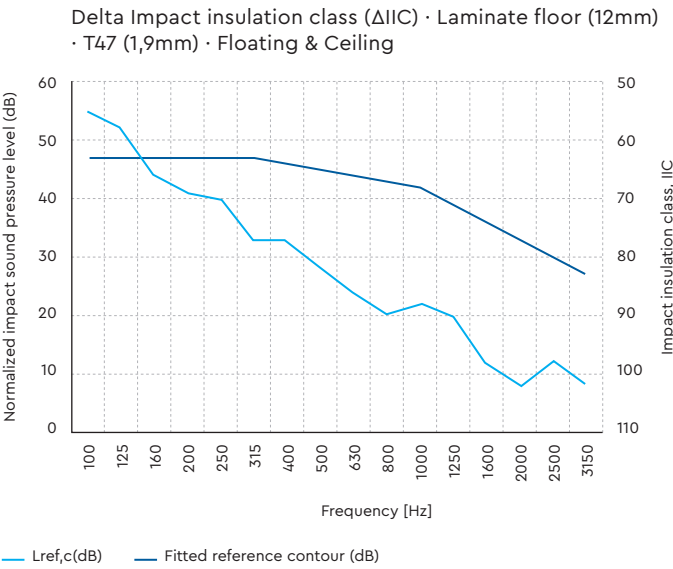
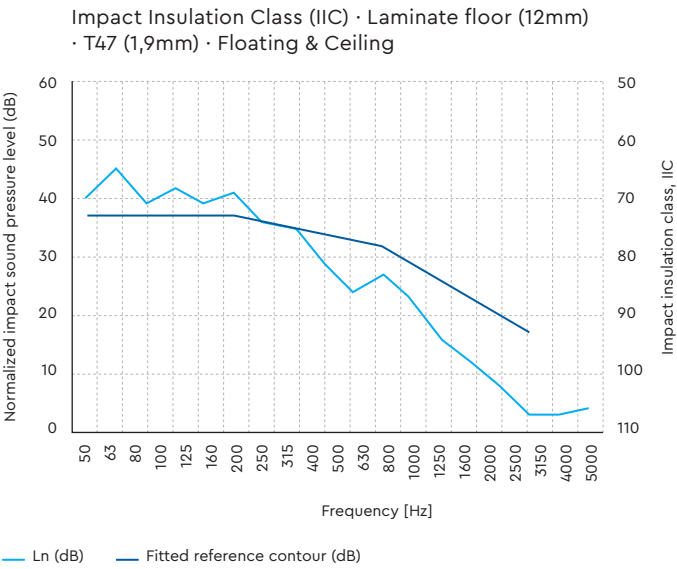

TEST APPARATUS (ΔL<sub>w</sub>)

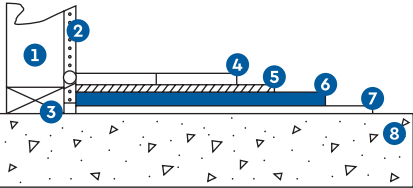

- 1 Wall
- 2 Wall board
- 3 Perimeter isolation barrier (optional)
- 4 LVT
- 5 Adhesive (recommended flooring producer)
- 6 Acousticork T47
- 7 Adhesive (recommended flooring producer)
- 8 Subfloor concrete slab

INSTALLATION

GLUED FLOORS

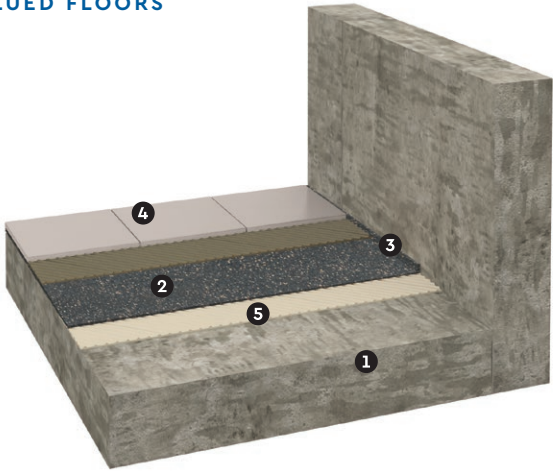

- 1 Reinforced concrete slab
- 2 Agglomerated cork resilient layer – Acousticork T47
- 3 Adhesive
- 4 Floor covering composed by glued wood floor
- 5 Adhesive (optional)

\*Product images and illustrations are for illustrative purposes only.

GENERAL INSTALLATION INSTRUCTIONS

The following installation instructions are recommended by Amorim Cork Solutions, but are not intended as a definitive project specification. They are presented in an attempt to be used with recommended installation procedures of the flooring installer.

Final Flooring

Always follow manufacturers recommended installation instructions, particularly when adhesives are recommended.

Recommended Adhesives

Wood-based floor to Acousticork: Water-Based Emulsion/  
Polyurethane Glue;

Important Notes

Never mechanically fasten the Acousticork T47 to the flooring floor as this will severely diminish its acoustical value.

For more detailed installation instructions, please contact us.

Never install a wood or laminate floor without vapor barrier (integrated or applied before the underlayment).

APPLICATION PROCESS • GLUED FLOOR

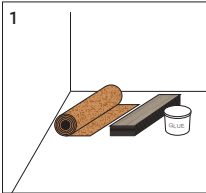

These are all the materials needed to install the underlayment.

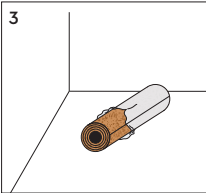
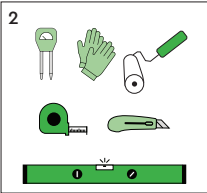

For the installation process, open the packaging 48 hours in advance and leave for acclimatization

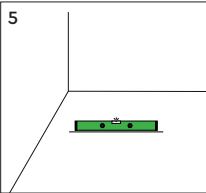
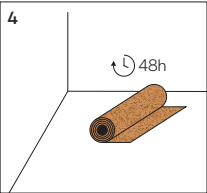

Subfloor preparation: Make sure that the subfloor is leveled, dry, clean and in good structural conditions.

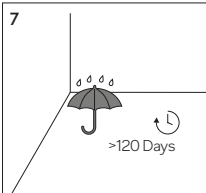
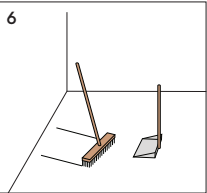

New concrete slabs must be left to cure for 120 days before installation.

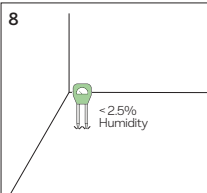

The humidity content of the substrate is critical: it must not exceed 2.5 % (MC).

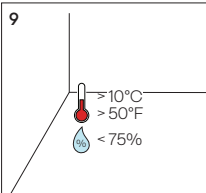

Air temperature should be above 10°C and air humidity below 75%.

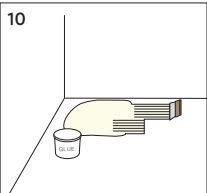

Optional step: apply the glue using a trowel. The installation of a moisture barrier is not necessary.

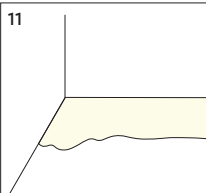

Optional step: we recommend the use of an adequate glue for the flooring to be installed.

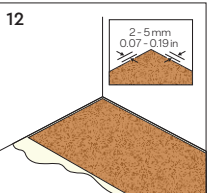

Install the underlayment directly on the adhesive, leave a space between the wall and the underlayment.

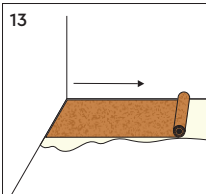

The underlayment should be installed in a perpendicular direction that you plan to install the final floor.

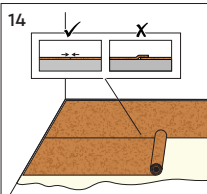

The underlay must cover the entire area without any gaps nor overlaps.

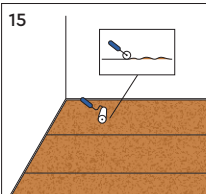

Use the paint roller to make sure the underlayment doesn't have any waves.

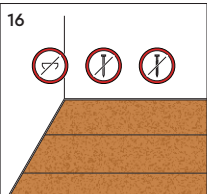

Never mechanically secure the underlayment with screws, nails or staples, since this may undermine its effectiveness.

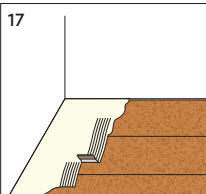

Apply the same glue on the underlayment.

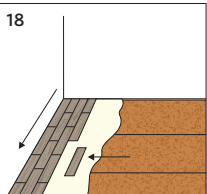

Install the flooring in a perpendicular direction to the underlayment, and let the whole floor dry completely before you start to use it.

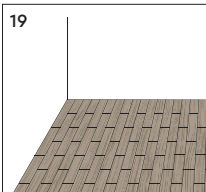

Always follow the flooring manufacturer's recommended installation instructions.

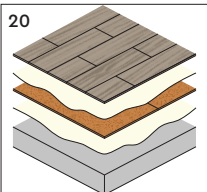

Total System.



For more information about this installation process and for non glued floors, access here